

# LED Low Profile Wall Pack



"Low Profile, really easy to install...." LED Today



# Specifications

<b>Wattage:</b>	24W	48W	80W
<b>Model Number:</b>	AE-L-WPLP-24	AE-L-WPLP-48	AE-L-WPLP-80
<b>DLC #:</b>	YR-WL90-W024-(5000K)	YR-WL90-W048-(5000K)	YR-WL112-W080-(5000K)
<b>DLC Partner:</b>	YAORONG		
<b>ETL/cETL:</b>	YES		
<b>Certifications:</b>			
<b>Voltage:</b>	120-277V		
<b>Power Factor:</b>	0.98		
<b>Frequency:</b>	50/60Hz		
<b>Lumens Efficiency:</b>	110LM/W		
<b>Kelvin (CCT):</b>	4000K/5000K		
<b>CRI:</b>	75		
<b>IP Rating:</b>	IP65		
<b>Lens:</b>	PC		
<b>Materials:</b>	Die Cast Aluminum		
<b>Finish:</b>	Black (Default)		
<b>LM70 Life Time:</b>	100,000		
<b>Dimming Availability:</b>	Optional		
<b>Warranty:</b>	5 Years		
<b>Temperature Range:</b>	-34°C ~ 54°C (-30°F ~ 120°F)		
<b>Weight:</b>	2.5KG 5.5LB	2.5KG 5.5LB	4.9KG 10.8LB
<b>Replacement Wattage:</b>	150W	250W	350W

# Dimensions

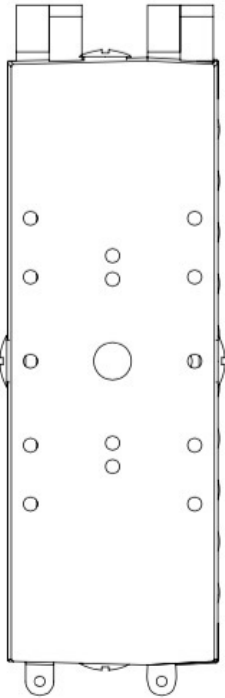
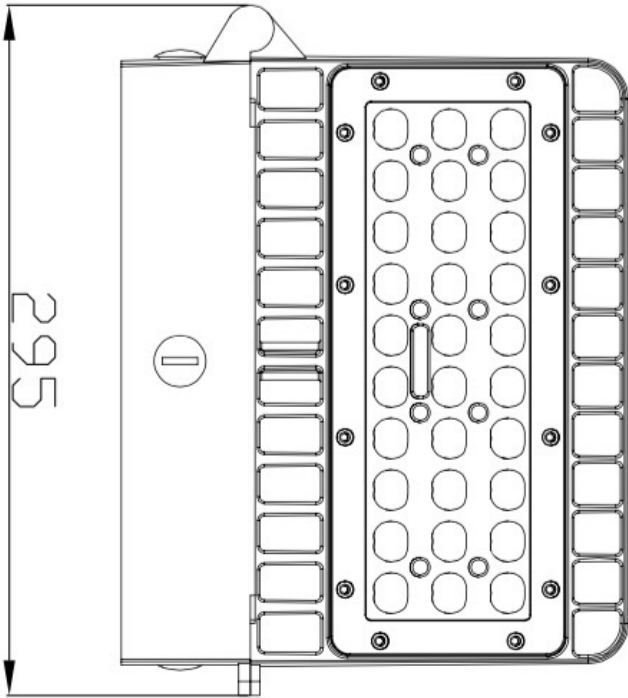
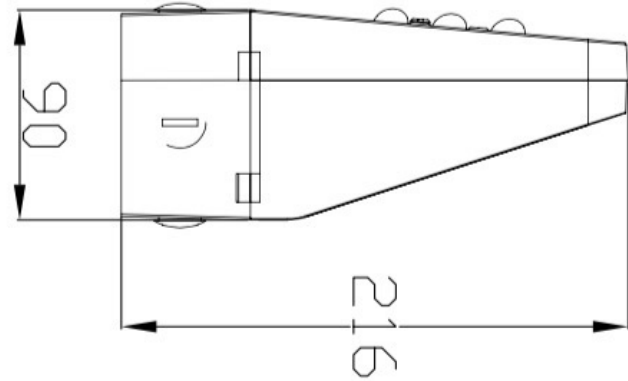

24W & 48W

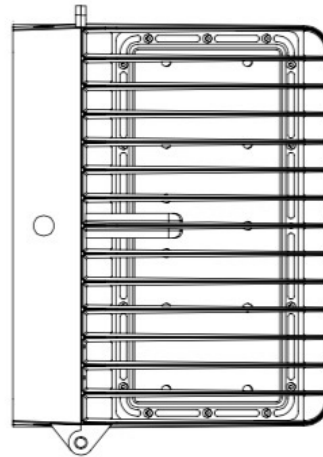
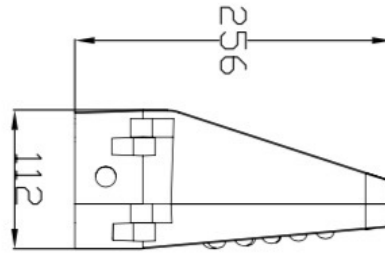
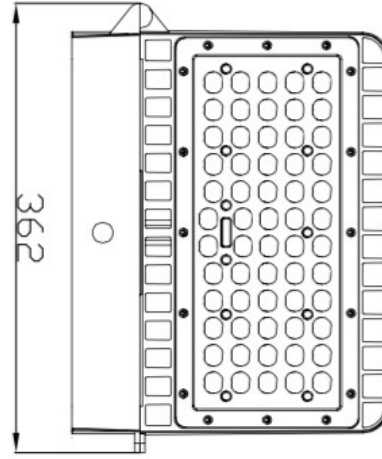
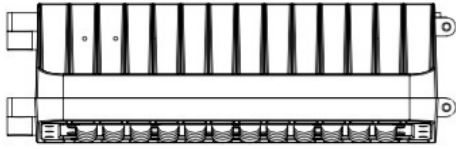

80W

# User Guide

## Note:

Please read this entire manual to fully understand and safely use the luminaire. The products can be used at the voltage of 100-277V AC, 50/60HZ, suitable for indoor and outdoor, moisture proof and dust proof. Specifications are subject to change without notice. Please visit [www.altechefficiency.com](http://www.altechefficiency.com) for the most recent product information.

## Unpacking:

1. Unpack and carefully examine the product.
2. Report any damage and save all packing materials if any part(s) were damaged during shipping.
3. Do not attempt to use the fixture if it is damaged.

## Before You install:

1. Before installing any light fixtures, read and understand all cautions, warnings, instructions and product labels. Failure to do so can result in injury and/or void the warranty.
2. CONSULT A QUALIFIED ELECTRICIAN TO ENSURE CORRECT BRANCH CIRCUIT CONDUCTOR.
3. The product should be installed and operated by a qualified electrician or technician in accordance with relevant local codes.
4. Risk of electric shock. Ensure that main power source is off when wiring or soldering the sections of the product.

## Maintenance:

1. Disconnect the product from the power supply prior to cleaning.
2. Use a dry or slightly moistened cloth for cleaning.
3. Never use any chemicals or abrasive materials for cleaning.

## Installation Instructions:



1

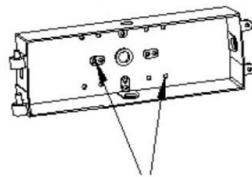

Using screws to install the power supply box onto the solid wall.

2

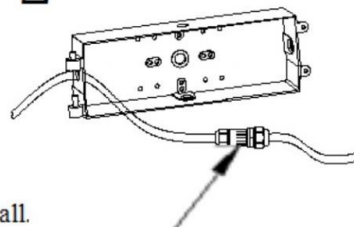

Open the wire-connector, connect the input wire, and then tighten the connector

3

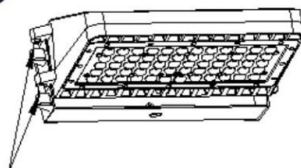

Thrust the heat sink body into the holes of power supply box

4

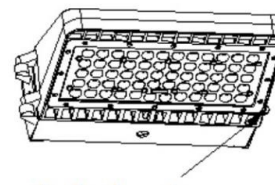

Close the body using screws and tighten them